

# ШТУЦЕРА ВВЕРТНЫЕ РЕГУЛИРУЕМЫЕ FR / Т-ОБРАЗНЫЕ, УПЛОТНЕНИЕ ТИП А

Резьба BSP/Метрическая резьба

Тип: 2053...3  
 Тип: 2054...3

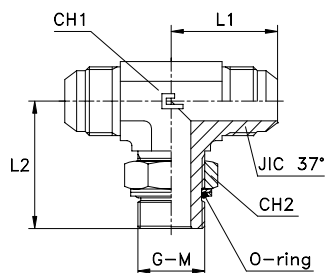

| Серия<br>JIC  | 20....<br>[bar] | 21....<br>[bar] | Код      | Ø трубы<br>M | Ø трубы<br>W | G     | L1   | L2   | CH1 | CH2 | JIC 37°   |
|---------------|-----------------|-----------------|----------|--------------|--------------|-------|------|------|-----|-----|-----------|
| УНИВЕРСАЛЬНАЯ | 350             | 350             | 205301.3 | 6            | 1/4          | 1/8   | 23   | 26   | 11  | 14  | 7/16-20   |
|               | 315             | 315             | 205302.3 | 8            | 5/16         | 1/4   | 24   | 32   | 14  | 19  | 1/2-20    |
|               |                 |                 | 205303.3 | 10           | 3/8          | 1/4   | 27,5 | 32   | 14  | 19  | 9/16-18   |
|               | 250             | 250             | 205304.3 | 12           | 1/2          | 3/8   | 32   | 37   | 19  | 22  | 3/4-16    |
|               |                 |                 | 205305.3 | 14-15-16     | 5/8          | 1/2   | 37   | 43   | 22  | 27  | 7/8-14    |
|               |                 |                 | 205306.3 | 18-20        | 3/4          | 3/4   | 42   | 49   | 27  | 36  | 1 1/16-12 |
|               | 200             | 200             | 205307.3 | 25           | 1            | 1     | 46   | 52   | 33  | 41  | 1 5/16-12 |
|               |                 |                 | 205308.3 | 30-32        | 1 1/4        | 1 1/4 | 53   | 58   | 41  | 50  | 1 5/8-12  |
|               | 160             | 160             | 205309.3 | 38           | 1 1/2        | 1 1/2 | 59   | 60   | 48  | 55  | 1 7/8-12  |
|               | 315             | 315             | 205310.3 | 6            | 1/4          | 1/4   | 24   | 32   | 14  | 19  | 7/16-20   |
|               | 250             | 250             | 205311.3 | 6            | 1/4          | 3/8   | 29   | 37   | 19  | 22  | 7/16-20   |
|               |                 |                 | 205312.3 | 6            | 1/4          | 1/2   | 31   | 43   | 22  | 27  | 7/16-20   |
|               | 350             | 350             | 205313.3 | 8            | 5/16         | 1/8   | 24   | 30   | 14  | 14  | 1/2-20    |
|               |                 |                 | 205314.3 | 8            | 5/16         | 3/8   | 29   | 37   | 19  | 22  | 1/2-20    |
|               | 250             | 250             | 205315.3 | 10           | 3/8          | 3/8   | 29,5 | 37   | 19  | 22  | 9/16-18   |
|               |                 |                 | 205316.3 | 10           | 3/8          | 1/2   | 31,5 | 43   | 22  | 27  | 9/16-18   |
|               |                 |                 | 205317.3 | 12           | 1/2          | 1/4   | 32   | 37   | 19  | 19  | 3/4-16    |
|               | 250             | 250             | 205318.3 | 12           | 1/2          | 1/2   | 34   | 43   | 22  | 27  | 3/4-16    |
|               |                 |                 | 205319.3 | 12           | 1/2          | 3/4   | 36   | 49   | 27  | 36  | 3/4-16    |
|               |                 |                 | 205320.3 | 14-15-16     | 5/8          | 3/8   | 37   | 37,5 | 22  | 22  | 7/8-14    |
|               |                 |                 | 205321.3 | 14-15-16     | 5/8          | 3/4   | 39   | 49   | 27  | 36  | 7/8-14    |
|               |                 |                 | 205322.3 | 18-20        | 3/4          | 1/2   | 42   | 47   | 27  | 27  | 1 1/16-12 |
|               | 200             | 200             | 205323.3 | 18-20        | 3/4          | 1     | 45   | 52   | 33  | 41  | 1 1/16-12 |
|               | 250             | 250             | 205324.3 | 25           | 1            | 3/4   | 46   | 50   | 33  | 36  | 1 5/16-12 |
|               |                 |                 | 205325.3 | 25           | 1            | 1 1/4 | 52   | 58   | 41  | 50  | 1 5/16-12 |
|               | 200             | 200             | 205326.3 | 30-32        | 1 1/4        | 1     | 53   | 58   | 41  | 41  | 1 5/8-12  |
|               |                 |                 | 205327.3 | 38           | 1 1/2        | 1 1/4 | 59   | 60   | 48  | 50  | 1 7/8-12  |

Примечание: Если вы хотите заказать фитинг из нержавеющей стали, пожалуйста, измените первые две цифры с 20.. на 21..

| Серия<br>JIC  | 20....<br>[bar] | 21....<br>[bar] | Код      | Ø трубы<br>M | Ø трубы<br>W | M      | L1   | L2   | CH1 | CH2 | JIC 37°   |
|---------------|-----------------|-----------------|----------|--------------|--------------|--------|------|------|-----|-----|-----------|
| УНИВЕРСАЛЬНАЯ | 350             | 350             | 205401.3 | 6            | 1/4          | 10x1   | 23   | 27   | 11  | 14  | 7/16-20   |
|               | 315             | 315             | 205402.3 | 8            | 5/16         | 12x1,5 | 24   | 31   | 14  | 17  | 1/2-20    |
|               |                 |                 | 205403.3 | 10           | 3/8          | 14x1,5 | 27,5 | 33   | 14  | 19  | 9/16-18   |
|               |                 |                 | 205404.3 | 12           | 1/2          | 16x1,5 | 32   | 38   | 19  | 22  | 3/4-16    |
|               | 250             | 250             | 205405.3 | 14-15-16     | 5/8          | 22x1,5 | 37   | 42   | 22  | 27  | 7/8-14    |
|               |                 |                 | 205406.3 | 18-20        | 3/4          | 27x2   | 42   | 50,5 | 27  | 32  | 1 1/16-12 |
|               | 200             | 200             | 205407.3 | 25           | 1            | 33x2   | 46   | 52,5 | 33  | 41  | 1 5/16-12 |
|               |                 |                 | 205408.3 | 30-32        | 1 1/4        | 42x2   | 53   | 58   | 41  | 50  | 1 5/8-12  |
|               | 160             | 160             | 205409.3 | 38           | 1 1/2        | 48x2   | 59   | 63   | 48  | 55  | 1 7/8-12  |
|               | 315             | 315             | 205410.3 | 6            | 1/4          | 12x1,5 | 24   | 31   | 14  | 17  | 7/16-20   |
|               | 350             | 350             | 205411.3 | 8            | 5/16         | 10x1   | 24   | 28   | 14  | 14  | 1/2-20    |
|               |                 |                 | 205412.3 | 8            | 5/16         | 14x1,5 | 24   | 33   | 14  | 19  | 1/2-20    |
|               | 315             | 315             | 205413.3 | 10           | 3/8          | 16x1,5 | 29,5 | 38   | 19  | 22  | 9/16-18   |
|               |                 |                 | 205414.3 | 12           | 1/2          | 18x1,5 | 32   | 38   | 19  | 24  | 3/4-16    |
|               |                 |                 | 205415.3 | 14-15-16     | 5/8          | 18x1,5 | 37   | 40   | 22  | 24  | 7/8-14    |
|               | 250             | 250             | 205416.3 | 14-15-16     | 5/8          | 20x1,5 | 37   | 42   | 22  | 27  | 7/8-14    |
|               |                 |                 | 205417.3 | 18-20        | 3/4          | 22x1,5 | 42   | 46   | 27  | 27  | 1 1/16-12 |
|               |                 |                 | 205418.3 | 25           | 1            | 27x2   | 46   | 52,5 | 33  | 32  | 1 5/16-12 |

Примечание: Если вы хотите заказать фитинг из нержавеющей стали, пожалуйста, измените первые две цифры с 20.. на 21..

\* Только в случае плановых заказов